



Farm Road, Edgware, HA8 9LR
£720,000 Freehold Council Tax Band E

REAL ESTATES
Est.1981

Estate Agents · Residential Sales · Investments · Lettings

A well presented, five bedroom two bathroom semi detached family home, situated on the popular Farm Road. Downstairs the property boasts a modern kosher kitchen and double reception room with air conditioning. Upstairs the home comprises two double bedrooms, a further single bedroom, family bathroom and utility cupboard. The loft conversion provides a further two bedrooms and bathroom. Private rear garden with side access. Scope for further extensions stpp. Offered to the market chain free.

* 5 Bedroom Semi Detached Home * Lounge/Dining Room * Separate Kosher Kitchen * Underfloor Heating in Bathrooms * Double Glazing Throughout * Loft Converted * Chain Free *

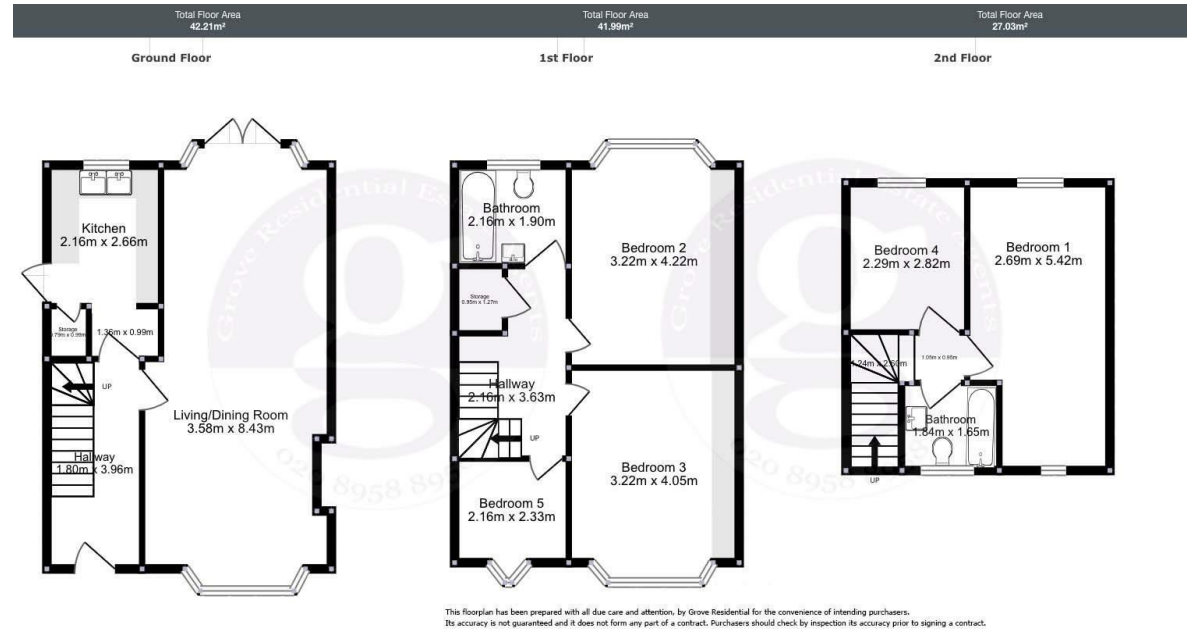

This floorplan has been prepared with all due care and attention, by Grove Residential for the convenience of intending purchasers. Its accuracy is not guaranteed and it does not form any part of a contract. Purchasers should check by inspection its accuracy prior to signing a contract.

